

i-tec USB-C Travel Dock 4K HDMI or VGA

i-tec USB-C Travel Docking Station, Multi-function Adapter, 1x HDMI 4K Ultra HD or 1x VGA, 1x Gigabit Ethernet, 2x USB 3.0 Port, 1x USB-C Power Delivery/Data Port, compatible with Thunderbolt 3, for Windows, Mac OS, Android, Chrome

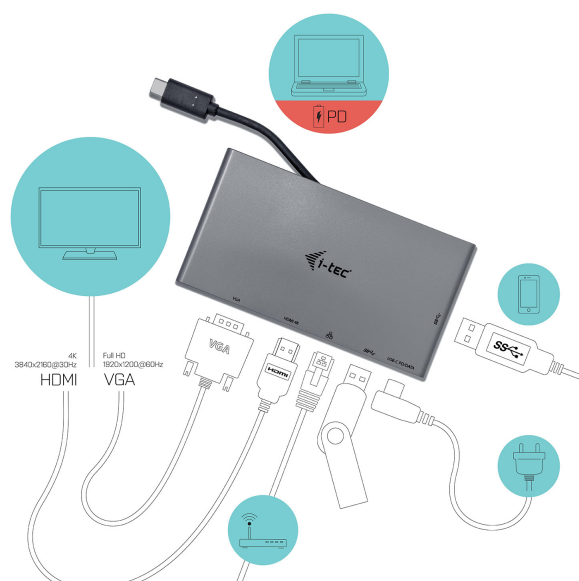

PRODUCT DESCRIPTION

i-tec USB-C Travel Docking Station thanks to its compact dimensions, low weight, and absence of the power adapter is a convenient companion for traveling users. The docking station will allow you easy and faster connection of your favorite equipment to your notebook/tablet/PC using a single USB-C cable.

The docking station is equipped with an HDMI and a VGA port for connecting to external monitor or data projector. However, you can use only one of these ports at a time, either the HDMI or the VGA port. If you connect monitors to both ports, the docking station will automatically give preference to the HDMI monitor and the VGA monitor will be disconnected. You can use modern plasma or LCD monitors or TV sets as the display equipment. The graphics chip, which makes the heart of the docking station, supports the HDMI (4K 3840x2160@30Hz) or VGA (Full HD 1920x1200@60Hz).

2x USB 3.0 ports (USB 3.1/3.0/2.0 compatible) make it easy to connect all of your favorite existing hardware, while the Gigabit Ethernet RJ45 port provides reliable, robust and high-speed internet connection, supporting 10/100/1000 Mbps speeds.

C31TRAVELDOCKPD is extremely compact and lightweight, so perfect for when you are on the move. It is quick and easy to set-up and with no external power supply or driver download, simply plug & play. Suitable for use with Macbook 2015, Chromebook Pixel 2015, Acer Switch Alpha 12, Dell XPS 13 and HP Elitebook Folio G1, as well as other devices with USB-C connectivity.

Additional Important Information:

- The video transfer is not supported via the USB-C 3.1 (Gen. 1) port. This function is not supported by USB-C docking stations but is supported by Thunderbolt 3 docking stations.
- Not all devices/systems with USB-C interface support the full standard functionality. Please ensure that your USB-C device supports DP alt mode and USB Power Delivery.

Product Overview & Features:

- Connect your notebook, tablet or smartphone to an additional monitor and your favorite hardware via a single USB-C or Thunderbolt 3 port
- Supports all devices with the USB-C interface with "DisplayPort Alternate Mode" and „Power Delivery”, or

Thunderbolt 3 port

- 1x HDMI port supporting the 4K resolution (3840x2160@30Hz) and stereo sound
- 1x USB-C 3.1 port to connect other USB-C devices, supporting a data transfer rate of up to 5 Gbps. To be used also as Power Delivery port for charging all notebooks, tablets, and smartphones with Power Delivery support.
- 2x USB 3.0 ports (USB 3.1/3.0/2.0 compatible), making it easy to connect all of your favorite existing hardware.
- Fast network and Internet access with Gigabit Ethernet RJ-45 port, supporting 10/100/1000 Mbps speeds
- Ideal for graphic designers, financial officers, gamers and other users working with more than one monitor simultaneously using the "Mirror" or "Extend" modes.
- 1x USB-C connector for connecting docking station to host (data transfer up to 5 Gbps, cable length 10 cm)
- Supports Windows 10 32/64 bit, Mac OS X, Chrome OS and Android 6
- Cross-brand and cross-platform compatibility

Please make sure to check a compatibility of your device, whether it meets all the requirements for an operation of the specific i-tec product, especially video output (Display Port Alt mode), and/or Power Delivery. If your device would not be fully compatible, your new i-tec product may not operate correctly. You may find the specifications your device (i.e. USB port), in a user manual supplied with your notebook/tablet/smartphone, or - alternatively - via customer service provided by a manufacturer of your device. If still uncertain, however, contact our service at support@itecproduct.com.

Long product description: i-tec USB-C Travel Docking Station, Multi-function Adapter, 1x HDMI 4K Ultra HD or 1x VGA, 1x Gigabit Ethernet, 2x USB 3.0 Port, 1x USB-C Power Delivery/Data Port, compatible with Thunderbolt 3, for Windows, Mac OS, Android, Chrome

PRODUCT FEATURES

- 1x integrated USB-C cable for connecting to the host device (10cm)
- Power Delivery: up to 60W
- Video ports:
 - 1x HDMI
 - 1x VGA
- Supported Resolutions:
 - 1 monitor - 1x HDMI → up to 4K/30Hz
 - 1 monitor - 1x VGA → up to 1920x1200/60Hz
- 1x USB-C port gen. 1 + PD (data + power delivery)
- 2x USB 3.0 port
- 1x Ethernet GLAN RJ-45 port (Realtek RTL8153)
- OS: Windows 10, macOS X, Android, Chrome OS Google with the latest updates
- Product dimensions: 129 x 69 x 17mm
- Product weight: 92g
- Package dimensions: 145 x 100 x 25mm
- Package weight: 145g

SYSTEM REQUIREMENTS

Hardware requirements:

- Device with an available USB-C or Thunderbolt™ 3 port

Power Delivery Requirements:

- Host device with an available USB-C or Thunderbolt™ 3 port that provides Power Delivery support

Video output requirements:

- Device with an available USB-C port with “DisplayPort Alternate Mode” support or a Thunderbolt™ 3 port

Operating system:

- Windows 10, macOS X, Android, Chrome OS Google with the latest updates

SPECIFICATION

Part Number	Product Description & EAN
C31TRAVELDOCKPD	i-tec USB-C Travel Dock 4K HDMI or VGA EAN: 8595611702389
-	i-tec USB-C Travel Dock 4K HDMI or VGA EAN: -
Hardware	
Bus type	USB-C, Thunderbolt-3
Ports/Connectors	
USB 3.0 TYPE A	2
USB-C DATA + POWER DELIVERY	1
HDMI	1
VGA	1
LAN RJ-45	1
System Requirements	
Hardware	Hardware requirements: Device with an available USB-C or Thunderbolt™ 3 port Power Delivery Requirements: Host device with an available USB-C or Thunderbolt™ 3 port that provides Power Delivery support Video output requirements: Device with an available USB-C port with “DisplayPort Alternate Mode” support or a Thunderbolt™ 3 port
Operating system	Windows 10 macOS X Android Chrome OS R51 or later Windows 10 - Automatic installation of OS drivers. Other operating systems - manual driver installation. Firmware updates automatically.
Other features	
Colour	Silver
Housing Material	Aluminium
Product Dimensions	129 x 69 x 17mm
Product Weight	92 g
Package Weight	145 g
Packaging Dimensions (LxWxH)	145 x 100 x 25mm
Support	
Warranty period	2 years
Technical support	lifetime

Package contents
Product
Protective packaging
Manual

For further information regarding setup or for answers to FAQ's, please visit our website [i-tec.cz](https://www.i-tec.cz). Specifications are subject to change without notice.

Updated 13.9.2019